

# PCR Thermal Cycler Genesy 96T

## HIGH PERFORMANCE INSTRUMENT THAT FITS THE REQUIREMENTS OF TODAY'S SCIENTIST

Genesy 96T--The new PCR thermal cycler from Tianlong, is quite easy to operate with a 7" color LCD touch screen. By taking advantages of its excellent thermo-block, Genesy 96T brings you homogeneous and accurate temperatures, rapidly and precisely controlled ramp rates and fast and reproducible PCR cycles. The programming of Genesy 96T is also remarkably simple and intuitive. Thanks to all these advantages, Genesy 96T is your ideal equipment for PCR.

## REPRODUCIBILITY

- > Genesy 96T block features remarkable gradient technology to ensure that ramp rates are identical in both gradient and normal mode.
- > Optimized perform assay crosses a maximal 40°C range via 12 gradient temperatures.

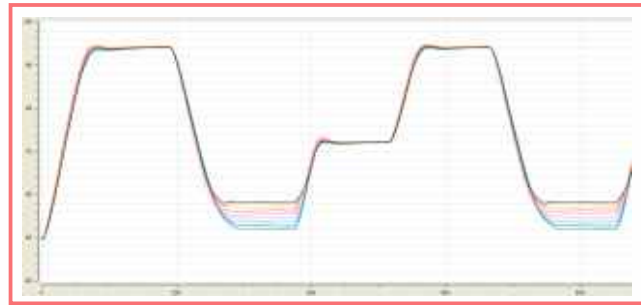

## FLEXIBILITY

- > 1000 experiment protocols can be saved in the machine
- > Protocols can be easily shared between different Genesy 96Ts via USB flash disk, personal protocols can also be saved in your USB flash disk to quickly setup your own experiment on any Genesy 96Ts.

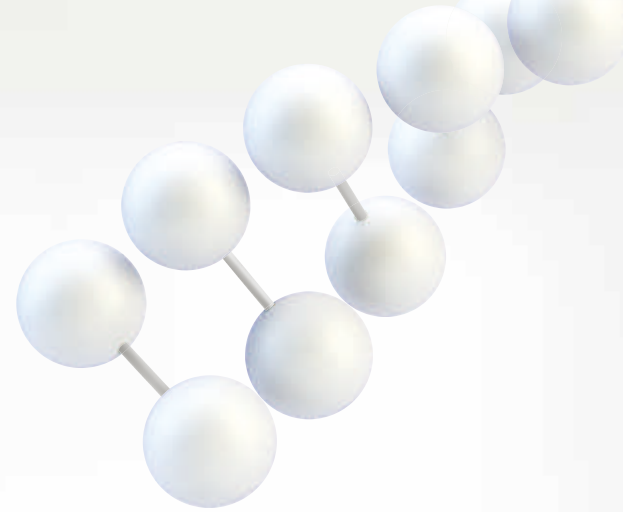

Intuitively software design, specialized user training is not required, friendly interface make it simple even for first time users.

Compact design with very small footprint, very easy to be easily moved

7" LCD touch screen, functions quickly accessible through simple, one-touch commands.

Unique power-off protection function can save all the set configurations after power off, and allow the experiment continues when power on.

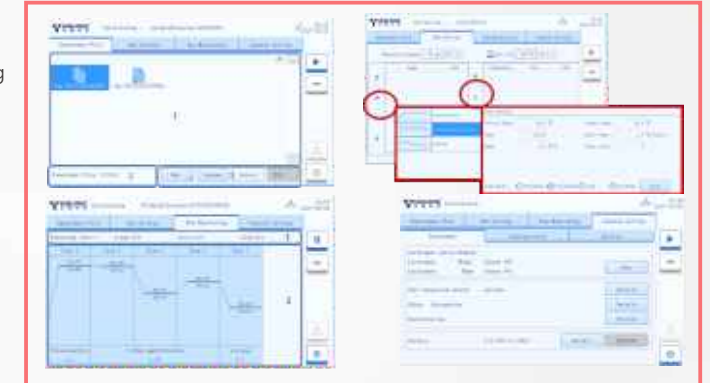

## CONSUMABLES

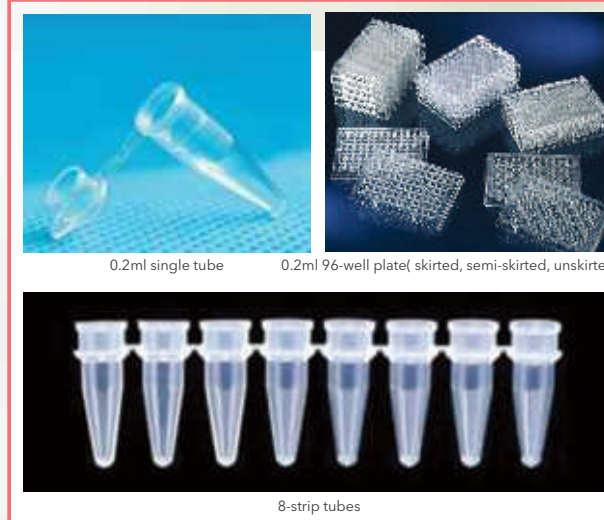

0.2ml single tube      0.2ml 96-well plate( skirted, semi-skirted, unskirted)

8-strip tubes

## SPECIFICATIONS

Items	Parameter
Thermo block	Aluminum
Sample Capacity	96 × 0.2 ml, 0.2 ml single tube, 8-strip tubes, 0.2 ml 96-well plate (skirted, semi-skirted, unskirted)
Temperature control range of the block	4°C ~ 99.9 °C
Temperature control mode	Tube mode & Block mode
Heating technology of the block	Peltier
Gradient block	12 row (horizontal)
Gradient range	0.2-20 °C
Gradient temperature range	30-99 °C
Lid temperature range	40-110 °C
Block homogeneity: 20 °C-72 °C 95 °C	±0.2 °C ±0.3 °C
Block temperature accuracy	±0.1 °C
Heating rate*	MAX 4.5 °C/s
Cooling rate*	MAX 4.5 °C/s
Interfaces	USB, Ethernet
Dimensions (W × D × H)	260 mm × 400 mm × 260 mm
Weight	12 Kg
Power supply	AC 100-240 V, 50-60 Hz
Max. Power consumption	600 VA